

Detroit Stoker Company

Aftermarket Replacement Parts

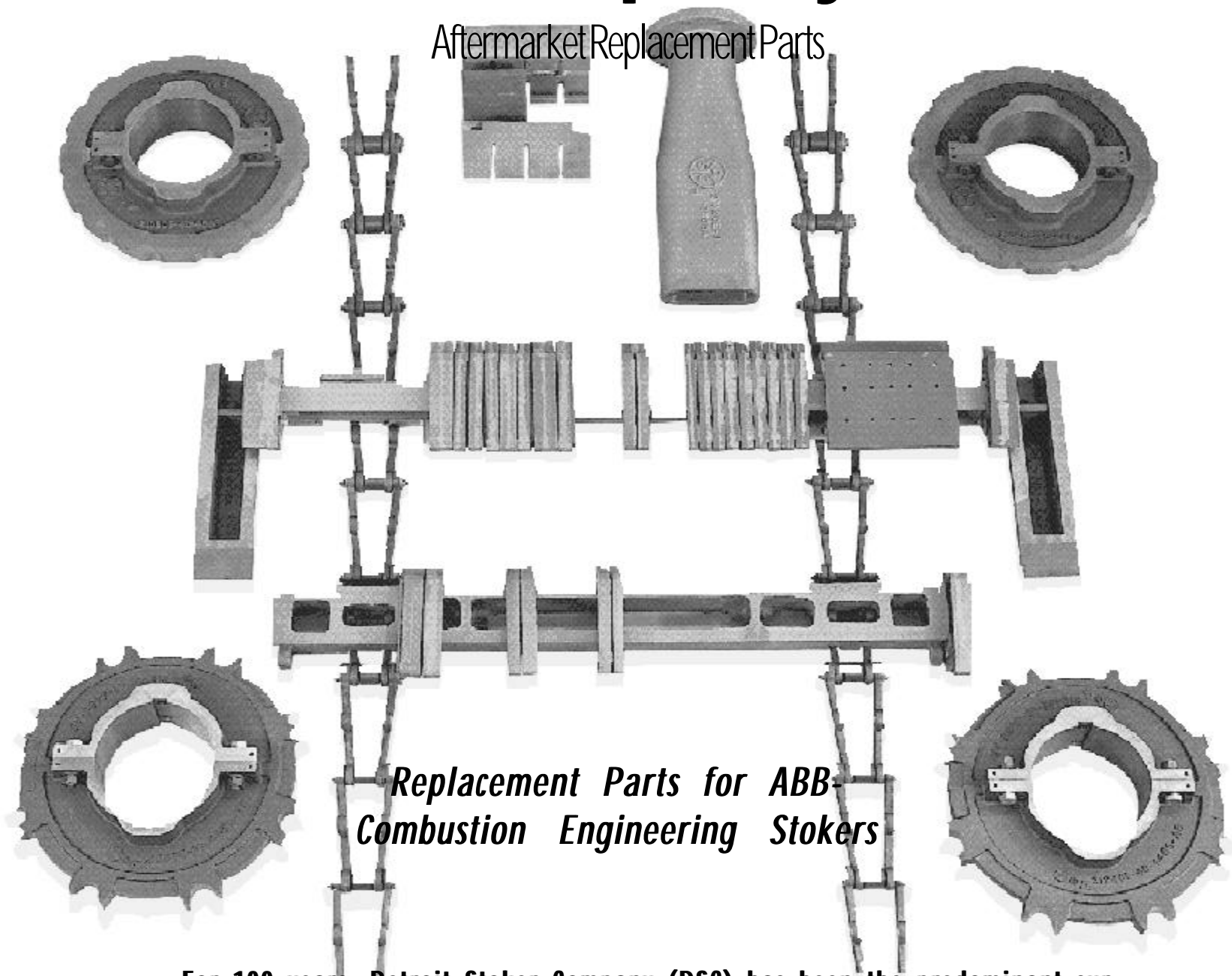

*Replacement Parts for ABB-
Combustion Engineering Stokers*

For 100 years, Detroit Stoker Company (DSC) has been the predominant supplier of stokers and combustion related equipment in North America. As the OEM for many types of stokers, DSC is fully committed to aftermarket services and complete plant life extension for most types of solid fuel burning equipment. DSC provides the highest quality replacement parts for all stoker manufacturer-

ers including:

- Detroit Stokers
- ABB-Combustion Engineering
- Coxo Stokers

- Lloyd Stokers
- Taylor Stokers
- B&W Jet Ignition
- American Engineering

- Canton Stokers
- Zurn Industries
- Hoffman Combustion Engineering
- Ladede Stokers
- Westinghouse Stokers
- Riley Stokers

Detroit Stoker Company manufactures most of the grate related castings/fabrications for each ABB-Combustion Engineering design. Metallurgical and design improvements are available. Many of these replacement parts are in stock and ready for immediate shipment.

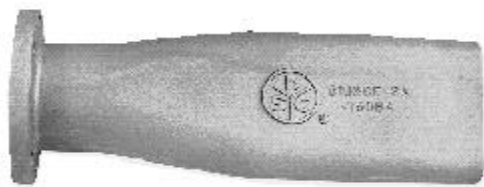

Discharge Nozzle for the cinder return system is available in Ni-hard for wear resistance and hardened ductile iron when excessive heat is a problem.



Front, Rear and Intermediate Grate Seals are available in heat resistant ductile iron to provide maximum service life.

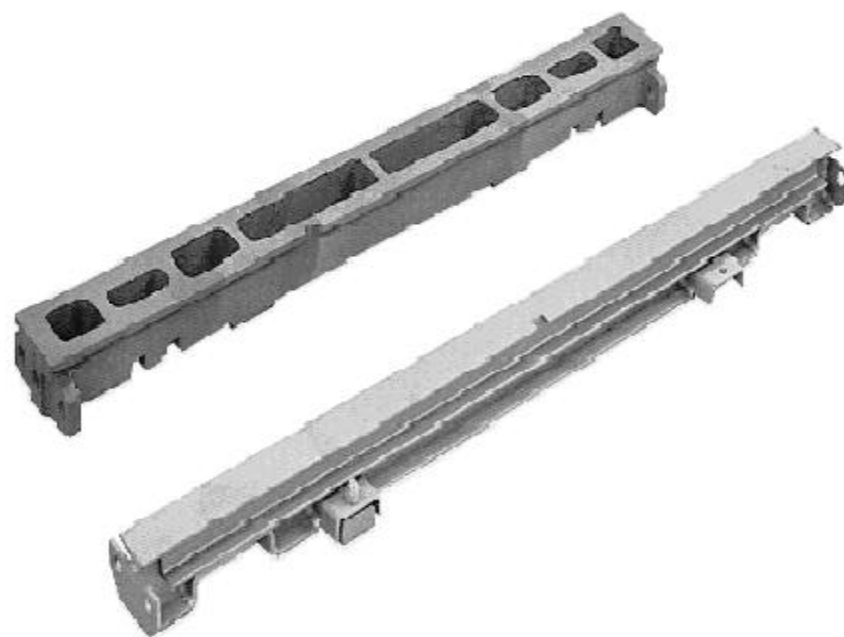

Different types of Grate Keys, End Key Plates and Removable Keys are manufactured from heat resistant ductile iron. Every Key is "Grate Bar" tested to insure proper fit before shipping. (Grate Keys for the Coxe and Lloyd stokers are also available.)

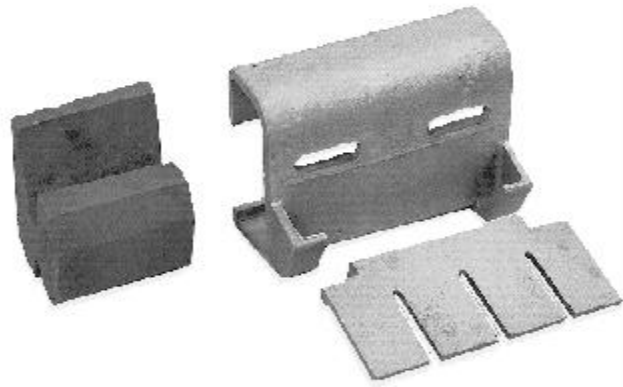

Backstops and Backstop Supports are manufactured from a cast alloy stainless steel to provide maximum service life. Backstop Tiles are produced from a heat/wear resistant silicon carbide.

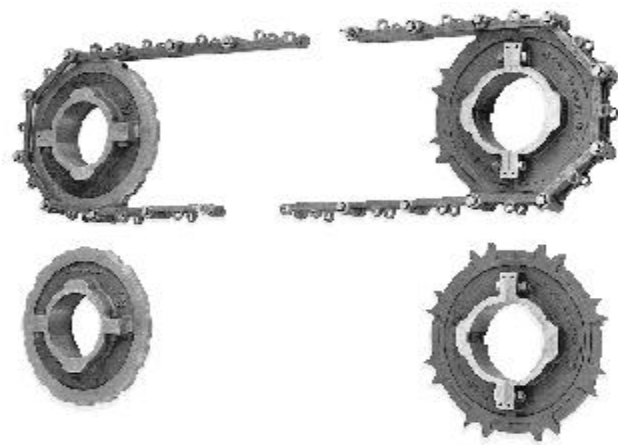

Grate Drive Sprockets and Toothless Idler Sprockets are manufactured for extended wear resistance. By improving upon the OEM's metallurgy, longer service life is achieved. Chain Link Assemblies are available in standard OEM design as well as Detroit's improved design using alloyed steel links and pins, which minimizes stretch and wear.

Fabricated Grate Bar with a variety of Grate Keys, End Key Plates and Chain Link Assemblies.

Fabricated and cast Grate Bars are available in a variety of different lengths. Improved heat resistant ductile iron cast Grate Bars are available where breaking and/or excessive heat is a problem.

DSC is uniquely qualified to provide innovative solid fuel firing solutions utilizing our total manufacturing, engineering and service capabilities.

Foundry

DSC is the only stoker manufacturer which operates its own foundry enabling us to deliver consistent casting quality and support your delivery requirements. Through DSC 's ability to analyze existing combustion conditions and materials, we can provide metallurgical enhancements to extend service life.

Construction Services

DSC is the only stoker manufacturer to provide complete combustion system service for all major stokers and related equipment. Services include:

- inspection
- training
- tune-up
- testing
- start-up
- turn key repairs/rebuilds
- engineering

Stocking/Consignment

As the largest manufacturer of stokers and replacement parts, DSC has the ability to offer stocking and consignment inventory options to meet your plant needs.

Experience

DSC's team is unparalleled when it comes to meeting the demands of today's industrial combustion requirements. For 100 years, we have provided parts and service for virtually every major stoker type with the quality and service expected by our customers.

Please contact Detroit Stoker Company or your local representative to learn more about how we can meet your exact requirements. Call 1-800-STOKER-4 or 1-800-786-5374.